

# RICMOTEC<sup>TM</sup>

## HIGH PERFORMANCE SIM-RACING EQUIPMENT

### USB PTT Button Box for Aftermarket Wheel

#### Installation Instructions

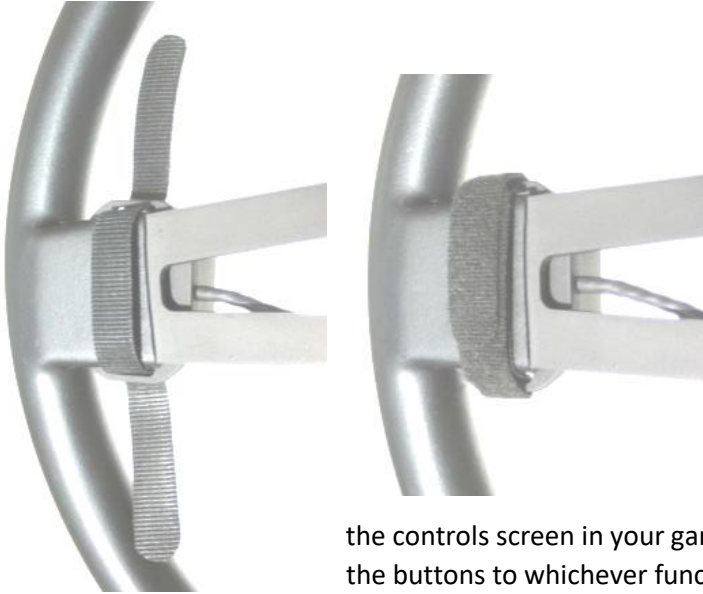

Secure the Push-to-Talk box to the wheel spoke as shown by threading the Velcro strap through the eyelets and then folding them onto themselves so they lock together.

Plug the USB cable mini connector into the box. Plug the standard USB A connector into your PC using a USB extension cable to extend its reach. The drivers will install automatically from windows update, please wait until this process completes.

You may now go into the controls screen in your game and map the buttons to whichever function you wish.



### **WARNING**

**The USB cable cannot withstand the extreme tension applied during wheel calibration. Please secure the USB cable at the wheel using a zip tie to reduce strain at the USB connector and disconnect the other end of the cable during wheel calibration. Damage to the cable or button box due to cable strain is not covered under warranty.**

The cable is a standard USB mini male connector on one end and USB A male on the other end. Any replacement cable will work.

#### **Need Help?**

If you run into any problems during the installation of the PTT box, please contact us directly at technical support at (305) 417-9241 or via email at [mail@ricmotech.com](mailto:mail@ricmotech.com).

Due to constant improvements to our products, the product you receive may vary slightly from the product shown in the illustrations.