

RICMOTECH™ HIGH PERFORMANCE SIM-RACING EQUIPMENT

Thrustmaster T3PA-PRO Springs Installation Guide



Tools Needed:

- #2 Phillips Screwdriver
- 2mm & 2.5mm Allen Wrench (Hex Key)

Items included:

- Gas pedal spring (green mark)
- Clutch pedal spring (yellow mark)

Before you begin, unplug the pedals from the wheel. Do not perform this installation on a statically charged surfaces such as carpet. The metal parts inside the Thrustmaster® pedal assembly may have sharp edges, please take the proper precautions.

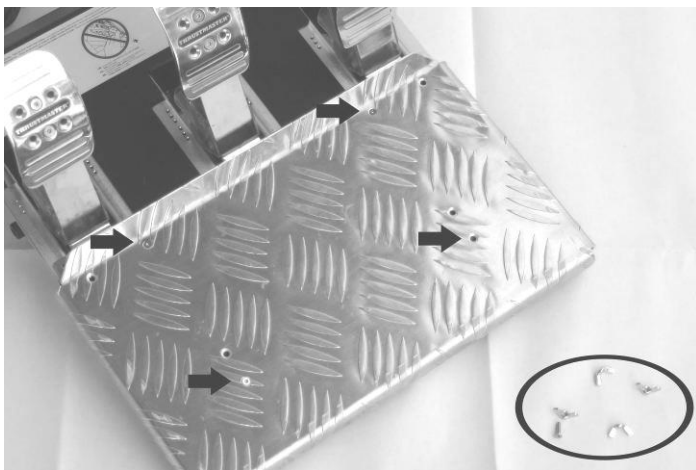

1. Using the 2mm hex wrench, remove the heel plate if your pedals are set up for "F1 Style" arrangement. There should be 4 screws securing the plate as indicated above, there may be extra holes which are left empty. There may be wing nuts securing them from underneath. Place the hardware in a bag and label the bag "heel plate". Set the heel plate and the bag aside.

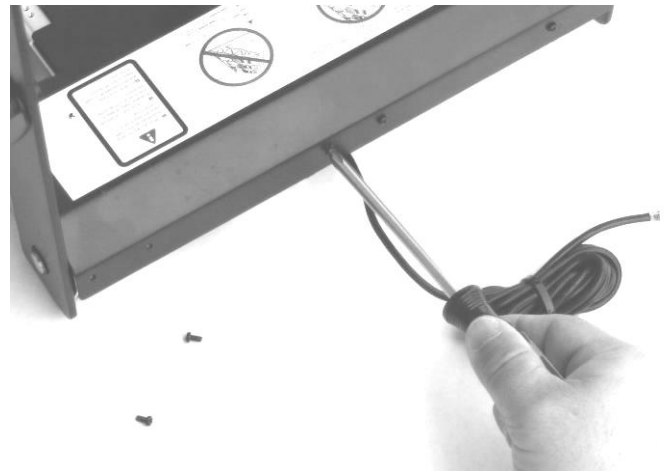

2. Remove the 6 black screws at the back of the pedal assembly. Place the screws in another bag and mark them "back screws." Set them aside.

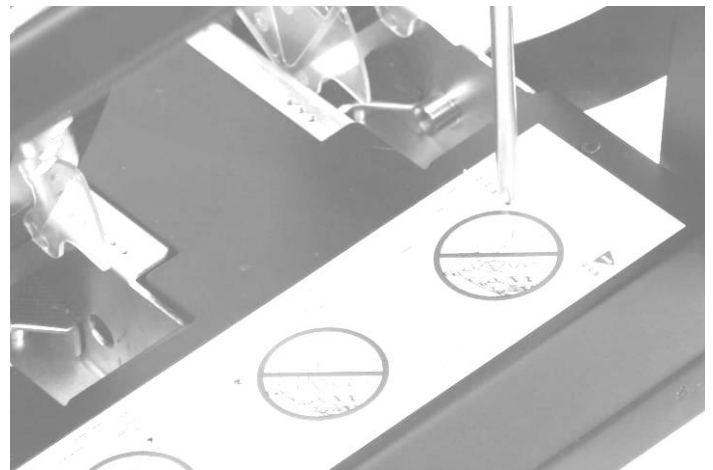

3. Remove the 4 black screws concealed by the warning label. Feel for them with your finger and dig them out with the tip of the screwdriver. Place the screws in another bag and mark it "top screws."

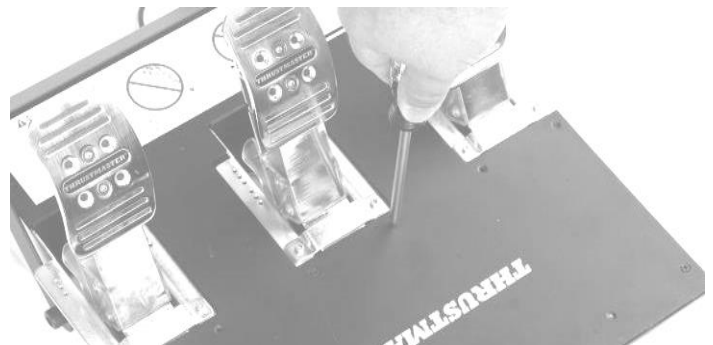

4. Remove 10 more exposed screws at the top of the cover plate and add those to the bag marked "top screws." The cover should now lift off, lift the front first and then 'unhook' the cover from the back. Set the cover and bags of screws aside.

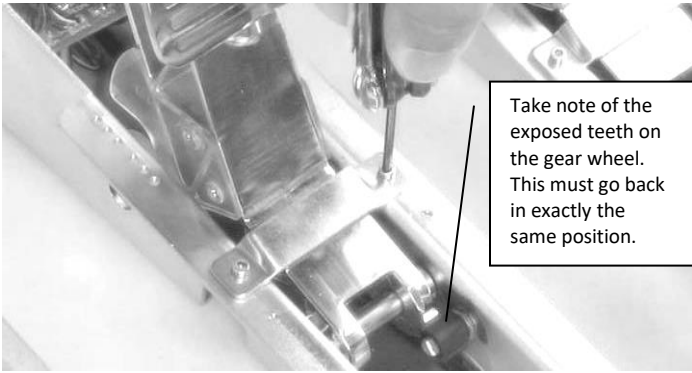

5. Remove the screw from one side of the gas pedal hold down bracket. There may be a nut securing it from underneath that may need to be removed first. Then loosen the screw on the other side, there is no need to remove the second screw completely. Swing the bracket clear and temporarily place screw and nut back on bracket as shown below (black arrow).

IMPORTANT: The gear wheel must go back in exactly the same position as it is from the factory.



6. Swing the pedal forward and remove the spring (white arrow) with the gas pedal spring. Smear some grease from the original spring onto the new spring.

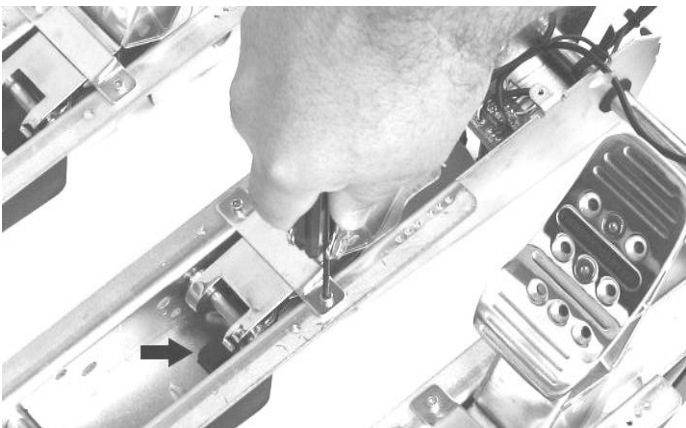

7. Flip the pedal back to its normal position making sure the potentiometer engages the pedal exactly as it was (black arrow). Compare this to the untouched clutch pedal and be sure they are the same. Secure the pedal hold down plate using the original screws.

8. Repeat steps 5 through 7 for the clutch pedal.



9. Place the top cover over the pedals, hooking it at the back first. The center pedal may have shifted to the side and may need to be centered in the opening to align correctly. Make sure all the wires are in their correct positions so they do not get pinched. Some of the glue originally used may have come undone. Re-install the 14 screws on the top of the cover plate. Then re-install the 6 screws to the back of the plate.

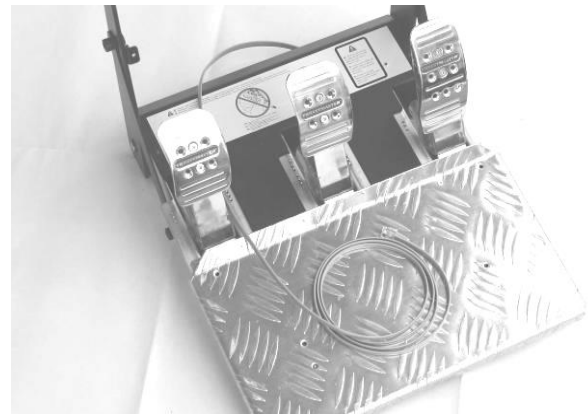

10. If previously removed, re-install the heel plate using the screws bagged as "heel plate".

Notice: Ricmotech is not responsible for any damage you may cause to your Thrustmaster® pedals during the installation of the springs.

Need Help?

If you run into any problems during the installation of the springs please contact us directly at tech support at (305) 417-9241 or via email at mail@ricmotech.com.

Due to constant improvements to our products, the product you receive may vary slightly from the product shown in the illustrations.

Copyright 2018, Ricmotech LLC

Thrustmaster® and T3PA-PRO are trademarks of the Guillemot® corporation and the terms are used for reference purposes only. Ricmotech is not affiliated with Thrustmaster®.